

SHREE SHYAM DEVELOPERS

312, Lake Town Block-A, Kolkata-700 089
Mob. : 91 98366 67771 / 91 98366 68881
E-mail : nirmalagroup4u@gmail.com

Date:

West Bengal Real Estate Regulatory Authority
Calcutta Green's Commercial complex, 1st Floor,
1050/2, Survey Park, Kolkata- 700 075.

Sub: Location Details of Project

Sir,

We are enclosing herewith the location details of the project NIRMALA PLAZA, with clear demarcation of land dedicated for the project along with its boundaries including the latitude and longitude of the end points of the project.

Thanking you

Yours faithfully,

SHREE SHYAM DEVELOPERS
Aayush Tekmal
Partner

SHREE SHYAM DEVELOPERS

312, Lake Town Block-A, Kolkata-700 089
Mob : 91 98366 67771 / 91 98366 68881
E-mail : nirmalagroup4u@gmail.com

A SITE PLAN AT MOUZA- KANKURI, I.L. NO. - 28, TOUZI No.- 1298/2833, DIVISON,
SUB- DIVISION -2 , DIHI- PANCHANNA GRAM, COMPROSED IN R.S. DAG NO. -150,
UNDER C.S./ R.S. KHATIAN NO. 117 & 118, PRESENTLY R.S. AND L.R. KHATIAN NO.-
110, WARD NO. 34 WITHIN THE JURISDICTION OF SOUTH DUM DUM MUNICIPALITY,
DISTRICT- 24 PARGANAS (NORTH).

LATITUDE :- 22.561567
22° 33' 41.6412 "

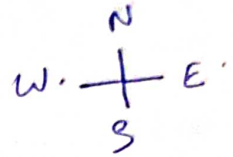

LONGITUDE :- 88.37369
88° 22' 25.2834 "

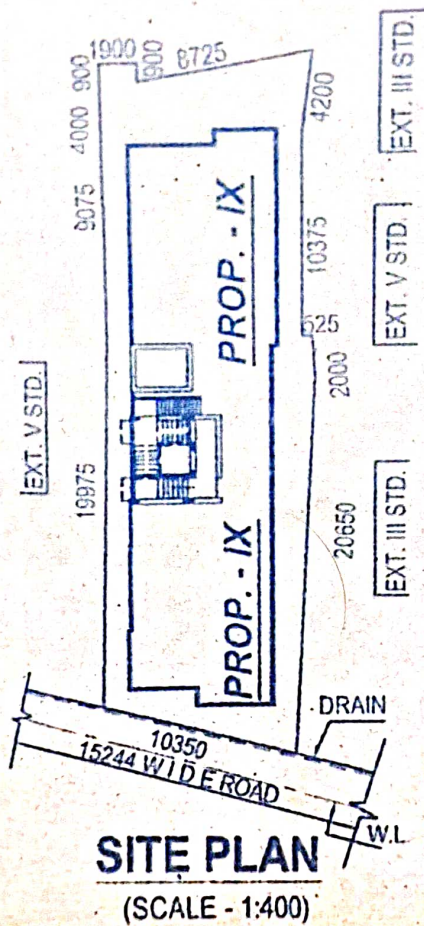

SHREE SHYAM DEVELOPERS

Aayush Tekrinal

Partner